



Developer



Corporate Office:
Chatterjee International Centre
33 A, Jawaharlal Nehru Road
Suite Nos. A1 & A2, 14th Floor
Kolkata 700 071
Tel : 033 4018 1111
marketing@thejaingroup.com
www.thejaingroup.com

For Booking Call:

9831503444 / 9903088846

ZRICKS

www.zricks.com



LIVE
IN A
DREAM

This brochure is a conceptual presentation. This is not a legal document. The developer reserves the right to change the layout plan, details, measurements and specifications.

www.Zricks.com

Possession Soon



For Booking Call:

9831503444 / 9903088846



Live In A Dream

Indulgence awaits you at Rajshat, the most premium location in the city.

Spread across lush green stretches, the exclusive condominiums come with six ultra-modern blocks.

With most of the flats facing south and the flourishing greenery, this is an address where dreams of calmness and relaxation come true, everyday.

Current status of the project



www.Zricks.com

Location Map



For Booking Call:

9831503444 / 9903088846



Dream Park, Near Garia Metro, Kolkata



Dream Ananda, Near Garia Metro, Kolkata



Dream Presidency Manor, Rajarhat, Kolkata



Dream Estates, Rajarhat, Kolkata



Dream Mills, Beliaganga Greater Road, Kolkata



Dream Apartments, Rajarhat, Kolkata



Dream Residency, Rajarhat, Kolkata



Dream Valley, Siliguri



Dream Palazzo, Rajarhat, Kolkata



Dream Best Western, Kolkata



Dream Hotel, Siliguri



Dream Hotel, Durgapur

The Jain Group is one of the most dynamic and reputed corporate bodies in the Finance and Real Estate sectors of Eastern India. Dream Homes from the Jain Group are now well known amongst the residential space buyers in Kolkata offering high quality living at great investment points. Having developed over a million square feet of residential and commercial real estate space the Jain Group has now launched a slew of real estate projects across the cities of Kolkata and Siliguri and other towns and cities like Durgapur, Guwahati, and Bhubaneswar. The Group has now diversified into 5-Star Hotels, IT Parks, Malls, Mills & Farm Houses and Infrastructure Development projects.



VISION	
Flat Marked	Gainable Area
A	1305 sqft
B	1305 sqft
C	1313 sqft
D	1405 sqft



DESIRE	
Flat Marked	Gainable Area
A	1405 sqft
B	1325 sqft
C	880 sqft
D	1213 sqft
E	1405 sqft

ZRICKS.COM



FANTASY

Flat Marked	Saleable Area
A	1315 sqft
B	975 sqft
C	1396 sqft
D	1365 sqft

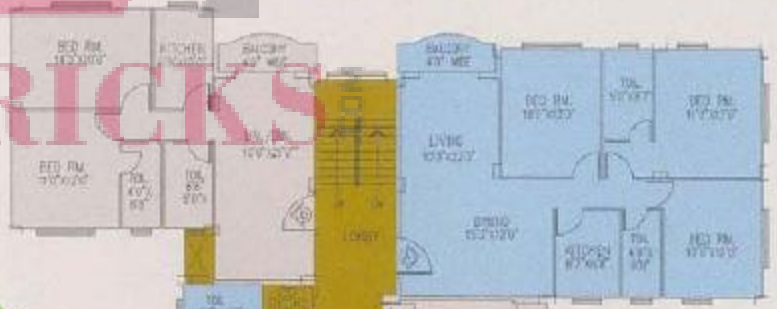
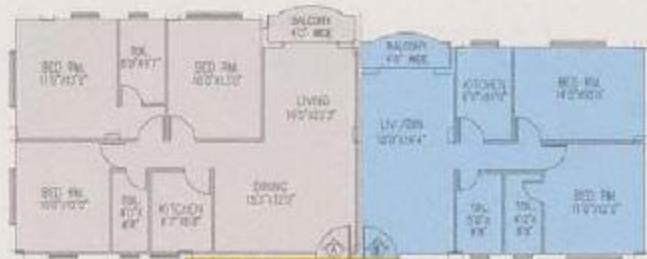

HOPE

Flat Marked	Saleable Area
A	1315 sqft
B	1365 sqft
C	1460 sqft
D	1000 sqft



ZRICKS





ASPIRATION	
Flat Marked	Estimable Area
A	1039 sqft
B	1039 sqft
C	1178 sqft
D	1435 sqft
E	1445 sqft
F	1310 sqft



AMBITION	
Flat Marked	Estimable Area
A	975 sqft
B	1545 sqft
C	1175 sqft
D	1365 sqft



Structure:RCC Frame structure

Elevation: A unique blend of ornamental and modern architecture

Exterior: Blending of weatherproof paint and other decorative

Finish Interior: Conventional brickwork with PoP finish

Flooring: Vitrified tiles in living ,dining & in all bedrooms and Anti –skid tiles in kitchen & toilets .

Staircase and lobby: Spacious staircase,elegant lobby and all floor

And all floor corridors with good quality Kota/granite stone

Kitchen: Granite top platform with stainless steel sink of repute

Make and glazed tiles dado upto 2 ft height above the platform

Doors: Entrance-polished flush doors with night latch good quality.Flush doors in all other rooms.

Windows: Anodized Aluminium windows

Electricals: Copper wirings in concealed conduits/AC point in

Master bedroom/Telephone,TV/cable point in living/dining/geyser

Point in attached toilet/sufficient light and fan points/Modular Switches.

Lift: Of reputed make in each block

Water supply: 24 hours of uninterrupted supply

Toilet: Anti-Skid tiles on the floors/ceramic tiles upto door height

Provision for hot and cold water supply in attached toilet/European

Style sanitary fittings /Elegant CP fittings.

The logo for Zricks.com features the word "ZRICKS" in a large, bold, pink, sans-serif font. To the right of "ZRICKS" is ".COM" in a smaller, black, sans-serif font. The logo is partially overlaid by a large, stylized, pink and grey graphic element that resembles a letter 'Z' or a similar shape.

www.Zricks.com